

**I.T.S.F.
FRANCE 2007
TABLE SOCCER WORLD
CHAMPIONSHIP SERIES**

MAY 17th to MAY 20th

**-
CDFAS - EAUBONNE
VAL D'OISE**

**REGISTRATION OPEN UNTIL
MAY 7th, 2007**



BabyFoot
BONZINI

CONTENT

❑ EVENT PRESENTATION.....	PAGE 1
❑ REGISTRATION.....	PAGE 2
❑ CATEGORIES AND ENTRY FEES	PAGES 3 - 4
❑ GAMEPLAY.....	PAGE 5
❑ TOP SEEDS.....	PAGE 6
❑ PRIZES.....	PAGE 7
❑ PROGRAM.....	PAGES 8 - 9
❑ PARTNERS.....	PAGE 10
❑ MAPS AND DIRECTIONS.....	PAGES 11 - 12
❑ ACCOMMODATION.....	PAGES 13 - 14
❑ INDIVIDUAL REGISTRATION FORM.....	PAGE 15
❑ NATIONAL TEAMS COMPETITION.....	PAGE 16 - 17
❑ NATIONAL TEAMS REGISTRATION FORM.....	PAGE 18

EVENT PRESENTATION

The French Federation of Table Soccer is proud to bring you the 2007 Bonzini Table Soccer World Championship Series event, which will take place as in 2006 at the:

CDFAS
(Centre Départemental de Formation et d'Animations Sportives)
in Eaubonne near Paris
May 17th to May 20th, 2007

This major competition is part of the International Table Soccer Federation (ITSF) World Tour. It benefits from the partnership with the **CDFAS** as well as the **CONSEIL GENERAL DU VAL D'OISE**.

More than 600 players from 15 countries and hundreds of spectators are expected for this international event.

10 world championship series titles are up for grabs:

Open Singles	Junior Singles
Open Doubles	Junior Doubles
Open Mixed	Senior Singles
Women's Singles	Senior Doubles
Women's Doubles	National Team

The French Team, who won the National Teams Competition last year, will try to hold on to their title this year again. You will find details of this competition together with a registration form at the end of this document.

Other competitions will also be organized:

- D.Y.P. (Draw Your Partner): Drawing of team members. 2 DYPs will take place: 1 DYP for the Pro Elite and Elite players, 1 DYP for the A/B/C series (both of them on Thursday); and 1 DYP on ITSF Official Tables (except Bonzini) on Sunday
- 2 Doubles competitions: 1 Pro Elite/Elite and 1 A/B/C Series to take place on Sunday

The **BONZINI** Company, table manufacturer since 1935, will provide the event with 80 tables.

All games will be free (tables are not coin operated) and the referees' compensation will be covered by the FFFT (there will be no extra charge to the players).

REGISTRATION

The competitions are open exclusively to permit holders of the Fédération Française de Football de Table (FFFT), and to members of the various table soccer federations around the world.

The wearing of sportswear is required of all participants.

The registration fees for non-French players will be set from case to case, depending on the nation of origin, i.e., its level of play and the players' traveling distance. This information will be forwarded to each federation.

We remind you that FFFT permits are available to all players during the year. It must however be requested at a club affiliated to the FFFT (a list of the clubs is available by contacting the FFFT offices or by going to the « clubs » page on the internet at www.francebabyfoot.com).

PLAYERS MUST WRITE THEIR LICENCE NUMBER AND THEIR CURRENT SERIES STATUS ON THE INDIVIDUAL REGISTRATION FORM. OTHERWISE THE REGISTRATION WILL NOT BE VALID.

Only foreign players can register without a licence number.

The deadline for sending registrations is set to:

MONDAY, MAY 7th, 2007

(Postal receipts are accepted as proof).

No registration forms will be accepted after that date.

An annex will be sent to ITSF member federations for the Table Soccer National Teams Competition.

For all inquiries and registration, contact



FFFT

27, rue Adolphe Moitié

44 000 Nantes

tel.: +33 (0)2 40 20 52 38

fax: +33 (0)2 40 20 44 59

email: ffft@francebabyfoot.com

site: www.francebabyfoot.com

CATEGORIES AND ENTRY FEES

I – Categories: Special cases

- For both Singles and Doubles, Juniors (under 18 years old on January 1st 2007), Women and Seniors (over 40 years old on January 1st 2007) must choose between playing in the Open categories (OS, OD) or in their specific categories (JS, JD, WS, WD, VS, VD): **they cannot play in both.**
Registration is free for Junior players.
- The P/E (Pro Elite and Elite) DYP and Doubles events are reserved specifically for Elite/Pro Elite-level players. In the same way, the A/B/C DYP and Doubles events are reserved for the A, B or C level players.
Only Pro Elite or Elite Women or Junior players can choose to play the DYP or A/B/C Doubles events (A/B/C fees will be applied).
Pro Elite and Elite players cannot play in the A/B/C DYP event and A/B/C DYP players cannot play in the Pro Elite and Elite DYP event.

II – Packages

- Pro Elite/Elite Package **(Pro Elite and Elite Seniors included)**: 1 Single*, 1 Double**, Open Mixed, P/E Double, P/E DYP
- A/B/C Package **(Pro Elite and Elite Women included)**: 1 Single*, 1 Double**, Open Mixed, A/B/C DYP (or P/E DYP for the Pro Elite and Elite Women), A/B/C Double (or P/E Double for the Pro Elite and Elite Women)

(*) 1 Single = Open, Women's, Senior OR Junior Singles

() 1 Double = Open, Women's, Senior OR Junior Doubles**

III – Entry Fees

Elite Package: €120
A/B/C Package or Women Package: €90
Junior Package: FREE

Categories not in packages:

Level / Category	OS	OD	OM	P/E DYP	A/B/C DYP	P/E DOUBLE	A/B/C DOUBLE
Elite	40 €	40 €	40 €	40 €		30 €	
A, B or C	30 €	30 €	30 €		30 €		20 €
Juniors	Free	Free	Free	Free	Free	Free	Free

OS = Open Singles OD = Open Doubles OM = Open Mixed

Level / Category	WS	WD	JS	JD	SS	SD
Elite	30 €	30 €	Free	Free	30 €	30 €
A, B or C	30 €	30 €	Free	Free	30 €	30 €
Juniors			Free	Free		

W = Women J = Junior 1st S = Senior 2nd S = Singles D = Doubles

GAMEPLAY

Every day, except on Sunday, the competition will end at 11:00 pm. The last match will be played between 10:00 pm and 10:30 pm.

All competitions begin with a qualification phase followed by an eliminatory phase in single KO (direct elimination).

All qualification matches are played in a single 7 point set.

All eliminatory matches are played with the following format: best of 5 sets, with a 2 point difference needed in the 5th set to a maximum of 8 points.

In chronological order

Categories	Qualification
P/E DYP (Thursday 9:00 am)	6 matches 100% qualified
A/B/C DYP (Thursday 9:00 am)	6 matches 100% qualified
Mixed Open (Thursday 12:00 pm)	4 matches 32 qualified max
Open Singles* (Friday 9:00 am)	6 matches 288 qualified max
Women's**, Junior** and Senior Singles (Friday 1:00 pm)	6 matches 100% qualified
Open Doubles (Saturday 9:00 am)	6 matches 160 qualified max
Women's, Junior and Senior Doubles (Saturday 10:00 am)	6 matches 100% qualified
A/B/C Doubles (Sunday 10:00 am)	4 matches 100% qualified
P/E Doubles (Sunday 10:00 am)	4 matches 100% qualified

* The first 3 Open Singles winners will be automatically qualified for the World Championships taking place in Saint-Vincent, Italy, October 25-28, 2007.

** The winner of the Women's Singles and the winner of the Junior Singles will also be automatically qualified for the World Championships.

TOP SEEDS

I – Top Seeds in Open Singles

Total number of Top Seeds: **16 players**

The first 8 foreign players in the ITSF Ranking are designated as the first 8 Top Seeds.

8 Wild Cards (ranks 9 to 16) are attributed to the first 8 players in the FFFT National Singles Ranking.

In case of withdrawal from a player holding a Wild Card, his rank will be awarded to the next player in the FFFT National Singles Ranking.

II – Top Seeds in Open Doubles

Total number of Top Seeds: **16 teams**

The first 8 teams in the ITSF Doubles Ranking are designated as the first 8 Top Seeds.

8 Wild Cards (ranks 9 to 16) are given to the best 8 teams in the FFFT National Doubles Ranking.

PRIZES

	OPEN SINGLES	OPEN DOUBLES	OPEN MIXED	Elite DYP	A/B/C DYP
1 st	1 Bonzini B90 + € 250	1 Bonzini B90 + € 900	€ 400	€ 500	€ 400
2 nd	€ 650	€ 1 100	€ 300	€ 350	€ 300
3 rd	€ 400	€ 700	€ 200	€ 250	€ 200
4 th	€ 300	€ 600	€ 200	€ 200	€ 150
5-8	€ 200	€ 350	€ 100	€ 150	€ 100
9-16	€ 150	€ 220			€ 50
17-32	€ 100	€ 150			
TOTAL	€5 200	€8860	€1 500	€1900	€1 880

	WOMEN'S SINGLES	WOMEN'S DOUBLES	JUNIOR'S SINGLES	JUNIOR'S DOUBLES
1 st	€ 200	€ 300	Trophy	Trophy
2 nd	€ 150	€ 200	Trophy	Trophy
3-4	€ 100	€ 150	Trophy	Trophy
5-8	€ 50	€ 60		
TOTAL	€750	€1 040	Trophy	Trophy

	SENIOR'S SINGLES	SENIOR'S DOUBLES	P/E DOUBLES	A/B/C DOUBLES
1 st	€ 200	€ 300	€ 500	€ 400
2 nd	€ 150	€ 200	€ 350	€ 300
3 rd	€ 100	€ 150	€ 250	€ 200
4 th	€ 100	€ 150	€ 200	€ 150
5-8	€ 50	€ 60	€ 150	€ 100
9-16				€ 50
TOTAL	€750	€1 040	€1900	€1850

Open Singles	Open Doubles	Open Mixed	Elite DYP	A/B/C DYP	Women's S / D	Junior's S / D	Senior's S / D	P/E Doubles	A/B/C Doubles
€5 200	€8 860	€1 500	€1 900	€1 850	€1 790	€500 Value	€1 790	€1 900	€1 850

Prizes are guaranteed, provided 300 packages at € 100 are sold and will be revised proportionately with the number of competitors.

10 % of the registration fees will go to the FFT.

Note that the competition tables are NOT coin operated.

AWARDS	€27 000
10% FFT	€3 000
TOTAL	€30 000
TROPHIES	€4 000
TABLES	€2 400
TOTAL	€36 400

PROGRAM – THURSDAY / FRIDAY

<u>Thursday, May 17th, 2007</u>	<u>Friday, May 18th, 2007</u>
<p>8:30AM Doors opening</p> <p>9:00AM Start of Qualifications P/E DYP and A/B/C DYP</p> <p>12:00PM Qualifications Mixed Open</p> <p>2:00PM Start of Eliminations P/E DYP, A/B/C DYP</p> <p>8:00PM 1st call for the Open Singles Distribution of Score Sheets</p> <p>9:00PM Mixed Open Finals</p> <p>10:00PM P/E DYP and A/B/C DYP Finals</p>	<p>8:30AM Distribution of Score Sheets Open Singles</p> <p>9:00AM Start of Qualifications Open Singles</p> <p>1:00PM Start of Qualifications Junior's, Women's and Senior's Singles</p> <p>1:30PM Start of Eliminations Open Singles</p> <p style="text-align: center;"><u>From 4:00PM to 5:00PM :</u> Official Ceremony Break in the Competition Presentation of National Teams</p>
<p style="text-align: center;">MATCH FORMAT</p> <p>- All elimination phases are in <u>Single KO</u> - Direct elimination</p> <p>- Best of 5 sets of 5 points each with a 2 point difference needed in the 5th set to a maximum of 8 points.</p>	<p>5:00PM National Teams Competition</p> <p>7:00PM OS/JS/WS/SS resume</p> <p>9:00PM 1st call for the Open Doubles Distribution of score sheets</p> <p>11:00PM Call for the last matches</p>

PROGRAM – SATURDAY / SUNDAY

<u>Saturday, May 19th, 2007</u>	<u>Sunday, May 20th, 2007</u>
<p>8:30AM Distribution of score sheets Open Doubles</p> <p>9:00AM Start of Qualifications Open Doubles</p> <p>10:00AM Start of Qualifications WD/JD/SD</p> <p>1:00PM National Teams Competition Finals</p> <p>3:00PM Eliminations Open Doubles</p> <p>3:00PM Eliminations WD/JD/SD</p> <p>7:00PM End of DYP registration Start of DYP elimination phase - open to players without a licence</p> <p>8:00PM P/E, A/B/C Doubles first call and distribution of score sheets</p>	<p>10:00AM Start of Qualifications P/E and A/B/C Doubles</p> <p>1:00PM Start of Eliminations A/B/C Doubles</p> <p>1:00PM Start of Eliminations P/E Doubles</p> <p>2:00PM Open Doubles Finals</p> <p>3:00PM DYP on ITSF Official Tables except Bonzini</p> <p>6:00PM P/E and A/B/C Doubles Finals</p>
<p>10:00PM Doubles Finals</p> <p>11:00PM Call for the last matches</p>	<p style="text-align: center;">MATCH FORMAT</p> <p>- All elimination phases are in <u>Single KO</u> - Direct elimination</p> <p>- Best of 5 sets of 5 points each with a 2 point difference needed in the 5th set to a maximum of 8 points.</p>

PARTNERS



THE DEPARTEMENT OF VAL D'OISE AND THE CDFAS



BONZINI – MAKER OF PLAYING TABLES



THE TOWN OF
FRANCONVILLE



CAVE BALLE LIEGE –
Provider of the
official balls



LE MOUV' RADIO STATION



THE FRENCH FEDERATION



THE INTERNATIONAL FEDERATION

MAPS AND DIRECTIONS

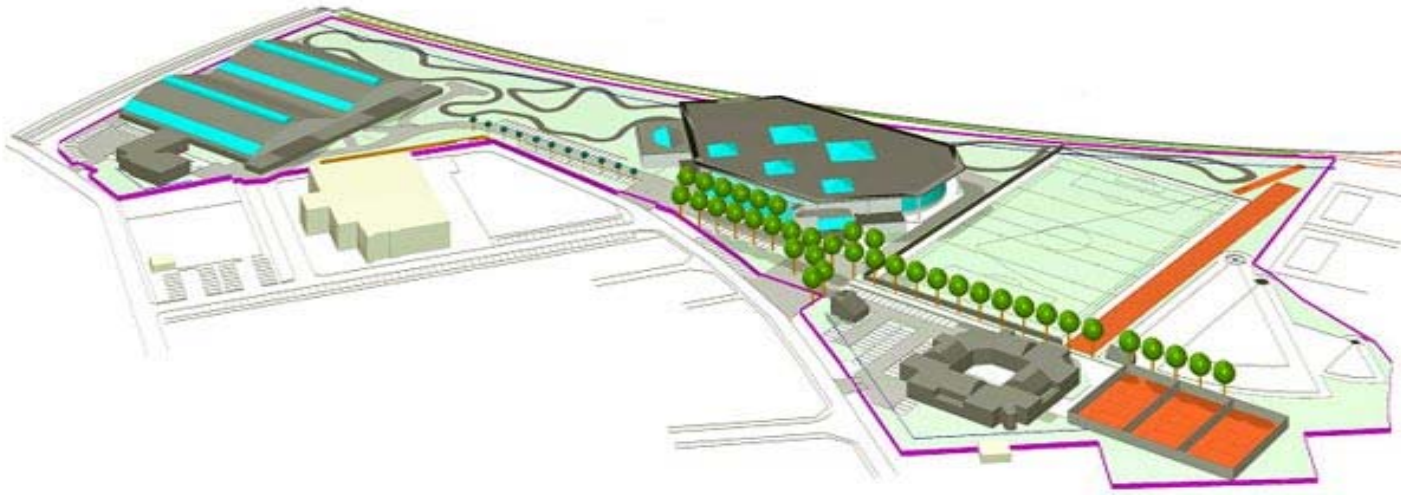

ROAD: Coming from Cergy or Paris, take A15 to exit N170 Sannois-Saint-Gratien, then follow Eaubonne direction; follow CDFAS signs, along the Michel Hidalgo stadium, and before reaching the Ermont Eaubonne train station, turn right on the Bouquinvilles street.

TRAIN: Ermont Eaubonne station (from Paris Nord). CDFAS is 0.4 Miles from the station

R.E.R. (subway): Ermont Eaubonne station (take the C1 line).

PARKING: On the site (130 spots) or R.E.R. station 0.2 Miles away (300 spots).

ADDRESS: Centre Départemental de Formation et d'Animations Sportives
64, rue des Bouquinvilles 95600 Eaubonne.

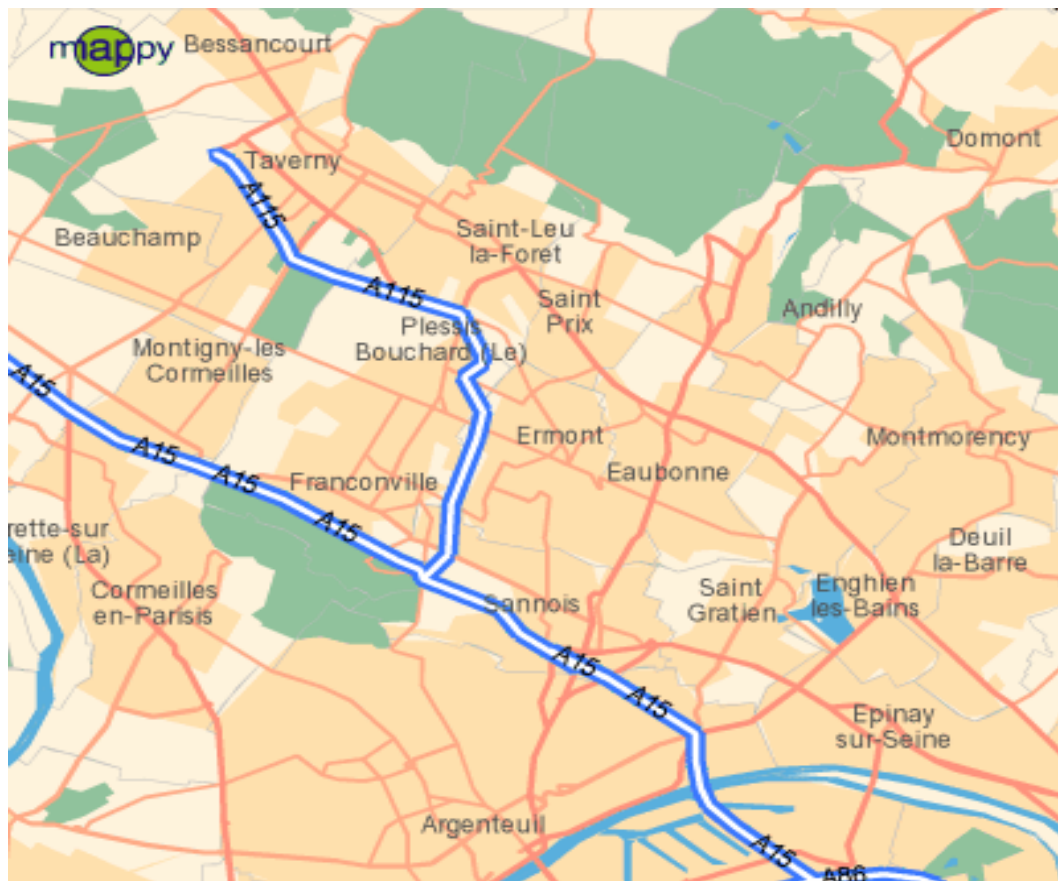

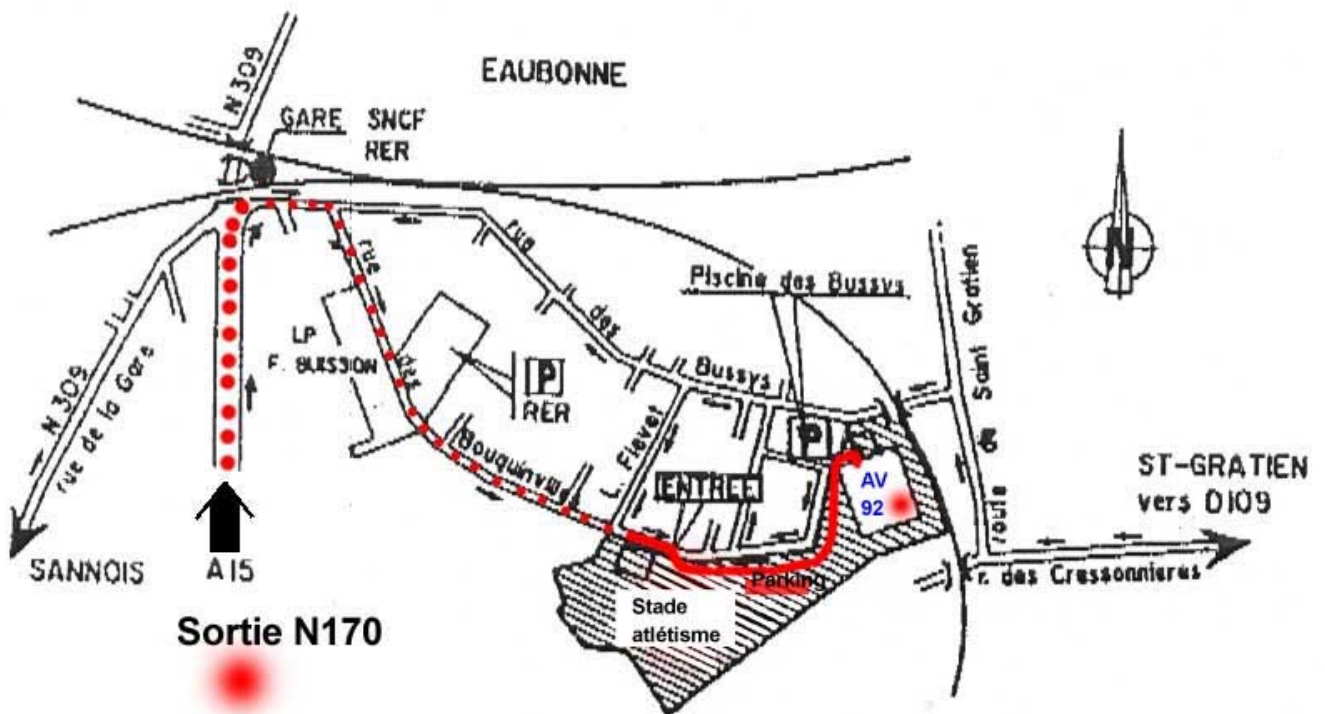

ACCOMMODATION

Hotels with special offers

Distance to CDFAS

L'escale At Roissy Charles de Gaulle Airport 95700 Roissy en France Tel 01.60.54.94.52		16 cabins + 16 apartments 52 € for 2 people 62 € for 4 people 10 € for breakfast	30 Km
Ibis Paris Gonesse RN 17 La Patte d'oie 95500 Gonesse Tel 01.39.87.22.22	<u>special fare for players</u>	5 rooms 39 € per room for 1 or 2 people 7 € for breakfast	15 Km
Ibis Paris Sarcelles 12, avenue Auguste Perret 95200 Sarcelles Tel 01.39.90.54.75 Fax 01.39.94.99.33	<u>special fare for players</u> <u>book as soon as possible</u>	14 rooms 22 €/pers. Double room. 3-4 people 7 € breakfast	11 Km
HOTEL CAMPANILE PARIS NORD TAVERNY Les Portes de Taverny Bois de Boissy 95150 Taverny Tel : 01.30.40.10.85	<u>special fare for players</u> <u>book as soon as possible</u>	30 € per room 7.20 € breakfast	9.2 Km

Hotels with standard prices

ETAP HOTEL 2 Bd Pasteur 95210 SAINT GRATIEN Tel : 08 92 68 32 65 Fax : 01 34 17 33 95	<u>book 2 months before event</u>	36 € per night 4 € breakfast	2.6 Km
FORMULE 1 CERGY ZONES ARTISANALES LES BOSQUETS 2 & 4 95540 Mery s/Oise Tel 08.91.70.53.13 Fax 01.34.21.67.02	<u>book 1 month before event</u>	27 € room for 1-2-3 people 3.40 € breakfast	16 Km
FORMULE 1 PONTOISE ST MARTIN RUE PIERRE DE COUBERTIN PLATEAU ST MARTIN 95300 PONTOISE Tel 08.91.70.53.59 Fax 01.30.75.93.63	<u>book 2 months before event</u>	27 € room for 1-2-3 people 3.40 € breakfast	20 Km
FORMULE 1 SARCELLES ZONE D'ACTIVITES 1 RUE DU VIGNOLLE 95200 SARCELLES Tel 08.91.70.53.90 Fax 01.34.19.48.98	<u>book 1 month before event</u>	28 € room for 1-2-3 people 3.40 € breakfast	12 Km

The 2007 Table Soccer World Championship Series - Eaubonne

ETAP PIERRELAYE CERGY-PONTOISE " La Patelle " R.N 14 – Z.A de Pierrelaye Ouest 95480 Pierrelaye Tel : 01.30.37.66.66 Fax : 01 30 37 38 54	95 rooms 32 € room for 1-2-3 people 4 € breakfast	21 Km
La Terrasse 119 r Gén Leclerc 95600 Eaubonne Tél 01 39 59 00 43	1 Double rooms 35 € pr room 5 € breakfast	1.2 Km
ETAP HOTEL SARCELLES AVENUE DE LA DIV. LECLERC 95200 Sarcelles Tel 01.39.94.56.56 Fax 01.39.94.88.66	37 € room for 1-2-3 people 4 € breakfast <u>book 1 month before event</u>	11 Km
ETAP HOTEL CERGY ST CHRISTOPHE 1, Avenue du Promenoir B.P. 8289 95804 Cergy pontoise Tel 01.34.24.06.54 Fax 01.30.38.93.95	36 € pr room 1-2-3 people 4 € breakfast <u>book 2 months before event</u>	23 Km
Bonfortel Louisiane 16Bis av Paris 95600 Eaubonne Tél 01 34 16 19 19 Fax 01 34 16 50 20	37 € in double room including breakfast <u>book 1 month before event</u>	3.4 km
ETAP HOTEL ARGENTEUIL VAL D'ARGENT 148, Route de Pontoise 95100 Argenteuil Tél 01.34.10.52.00 Fax 01.34.10.87.42	42 € pr single room 42 € pr double or triple room 4 € breakfast	10 Km
ETAP HOTEL ARGENTEUIL QUAI DE SEINE Z.I. des Bords de Seine 118, Rue Michel Carré 95100 Argenteuil Tél 01.39.47.67.67 Fax 01.39.61.52.61	37 € pr room 1-2-3 people 4 € breakfast <u>book 1 month before event</u>	8 Km
CHEZ PIERRE "AU BON COIN" 154 rue Plessis Bouchard 95130 Franconville Tel : 01.34.13.88.55	11 Rooms 35 € for 2 people 45 € for 3 people 5 € breakfast <u>book 15 days before event</u>	5.3 Km

INDIVIDUAL REGISTRATION FORM

N°

NAME (in capital letters)

Last name: _____

Club: _____

First name: _____

League: _____

Licence number (**compulsory**): _____ **OR** **Country**: _____

REGISTRATION – CHOOSE ONE FORMULA FROM THE TWO BELOW

Please do not write in the boxes that are reserved for the FFTF.

A - PACKAGE

☐ **Elite/Pro Elite: €120**

☐ **A/B/C: €90**

☐ **Junior: Free**

☞ **For Women or Junior Elite players (with A/B/C package), indicate which DYP you wish to play:**

☐ **Elite DYP**

☐ **A/B/C DYP**

☞ **For Juniors (with A/B/C package), Women and Senior players, indicate which Singles competition you wish to play:**

☐ **Open Singles**

☐ **Women's Singles**

☐ **Senior's Singles**

☐ **Junior's Singles**

☞ **For all categories: indicate your choice of Doubles competitions as well as your partner's name:**

☐ **Open Doubles**

Partner: _____

☐ **Women's Doubles**

Partner: _____

☐ **Senior's Doubles**

Partner: _____

☐ **Junior's Doubles**

Partner: _____

☐ **Elite Doubles**

Partner: _____

☐ **A/B/C Doubles**

Partner : _____

For all: indicate whether you'll be playing Open Mixed and indicate your partner's name:

Open Mixed:

☐ **Will play**

☐ **Will not play**

☐ **Don't know**

Please write the full name of your **partner**: _____

B - PER CATEGORY

☐ **Open Singles (Elite 40 € A/B/C 30 €)**

☐ **Open Doubles (Elite 40 € A/B/C 30 €)**

Partner: _____

☐ **Open Mixed (Elite 40 € A/B/C 30 €)**

Partner : _____

☐ **DYP (Elite 40 € A/B 30 €)**

☐ **Women's Doubles (30 €)**

Partner : _____

☐ **Junior's Doubles < 18 y.o.(0 €)**

Partner : _____

☐ **Senior's Doubles > 40 y.o.(30 €)**

Partner : _____

☐ **Women's Singles (30 €)**

☐ **Junior's Singles (0 €)**

☐ **Senior's Singles (30 €)**

☐ **P/E Doubles (30 €)**

Partner : _____

☐ **A/B/C Doubles (20€)**

Partner : _____

TOTAL: € _____ (by cheque made to the FFTF)

Date: _____

Cheque number: _____

Issued by: _____

PLAYER'S SIGNATURE

The organizing body is not responsible for any events - 15 -
happening outside the organization of the tournament.

NATIONAL TEAMS COMPETITION **at the WORLD CHAMPIONSHIP SERIES**

Team Composition

- A regular national team is made up of 8 players (6 men and 2 women).
- Beside the 8 regular players, each team can have 2 (and only 2) reserve players (1 man and 1 woman) who will be able to rotate with regular team members, but note that no changes of players will be allowed within 2 hours before each game. So there can not be more than 8 different players' names (6 men and 2 women) on the score sheet.
- The minimum number of players allowed in a team is 5.
If there is no woman in a team, then the Women's Singles and Doubles matches will be forfeited, and that team will automatically lose the points for those 2 matches.

Competition format

- The competition is played with a system of direct elimination.
- When 2 teams meet, they play 8 matches against each other: 4 matches in Singles followed by 4 matches in Doubles.
- A match consists of 1 game of 7 points. The match must be won by two clear points.
- **If, at the end of the encounter, both teams have won an equal number of matches (4 each), an extra match will be played in Doubles, to be played by 2 players of each team who have not yet taken part in Singles.**

Games will be played in the following order - 2 matches will take place at the same time
(→ see score sheet)

- Singles 1 (S1) and Women's Singles (S2)
- Singles 3 (S3) and Singles 4 (S4)
- Doubles 1(D1) and Women's Doubles (D2)
- Doubles 3 (D3) and Doubles 4 (D4)

For the draw, 4 nations will be designated as top 'Seeds':

- the host country
- 3 nations designated by the tournament director and the ITSF Delegate as the best nations playing on the tournament's Official Table. Note that starting in 2007, the World Ranking of Nations will be used to designate these 3 nations.

NATIONAL TEAM'S REGISTRATION FORM

COUNTRY: _____

COACH

(does not have to be member of the playing team)

Last Name _____

First Name _____

TEAM MEMBERS

(Minimum 5 players)

Last Name _____

First Name _____

Name (Woman) _____

First Name _____

Last Name _____

First Name _____

Name (Woman) _____

First Name _____

Last Name _____

First Name _____

Last Name _____

First Name _____

Last Name _____

First Name _____

Last Name _____

First Name _____

RESERVE PLAYERS (when applies)

Last Name _____

First Name _____

Name (Woman) _____

First Name _____

**val
d'oise**
le département

Table Soccer World Championship Series

2007

itsf
INTERNATIONAL TABLE SOCCER FEDERATION
world championships series

**DU 17 au 20
MAI 2007**

au CDFAS

**64 rue des Bouquinilles
EAUBONNE • SAINT-GRATIEN**

Infos : 02 40 20 52 38

www.valdoise.fr

www.francebabyfoot.com

www.table-soccer.org

entrée gratuite



02 40 20 52 38

